

FT SRC SEAT VALVES

Versions 7, 9, 77, 79, 97 and 99



Flowtrend, Inc. is not associated with, nor a distributor for, any of these manufacturers. Any name, brand, model or part number is for descriptive purposes only. Our components will fit other manufacturer's equipment and carry the OEM warranty. Alfa Laval® is a Registered Trademarks of Alfa Laval, Inc.

11512 SPACE CENTER BLVD, HOUSTON TEXAS 77059
P +1 281 990 8582 F +1 281 990 8644

WWW.FLOWTREND.COM

FLOWTREND

SMARTER, FASTER FLUID HANDLING SOLUTIONS

Replaces the Alfa Laval® SRC Seat Valve

- Air operated seat valve
- Sanitary, flexible design: stop valve with 2-3 ports, divert valve with 3-5 ports
- Remotely controlled with compressed air
- Reliable: few, simple moving parts
- All parts 100% interchangeable with OEM

Suitable for

The FT SRC valve is designed for high volume liquid processing where correct alignment of a clean-in-place valve must be maintained under severe operating conditions.

Features

- Open yoke with visible stem coupler
- Heavy duty clamps
- Polished surface areas minimize crevices that hide and trap bacteria
- Repairable actuator
- Standard stock item

Materials

Materials	AISI 316 Stainless Steel, Wetted parts AISI 304 Stainless Steel, Non-Wetted parts
Surface Finish	ID: 32Ra Standard
Wetted Seals	EPDM
Non-Wetted Seals	NBR
End Connections	Clamp

Technical Data

Available Sizes	1"-4" [25-101mm]
Max Pressure Range	145 psi (10 bar)
Min Pressure Range	Full vacuum
Temperature Range	14° to 285°F [-10° to 140°C] EPDM
Actuator Functions	NO [air-to-close], NC [air-to-open], AA [air-to-open, air-to-close]
Actuator Pressure	72-116 psi (5-8 bar)

Options

- Butt weld end connections
- Control tops
- High Pressure [HP] Actuators
- Larger actuators for valve sizes 1.5"-2.5"
- Tangential port bodies [TL & TR]
- Long Stroke actuators [LS]
- Manually operated valve [SMO]
- Manually regulating valve [SMO-R]



FT SRC SEAT VALVES

Versions 7, 9, 77, 99, 97, and 79

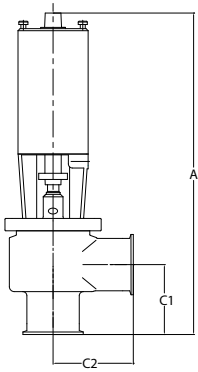

FT SRC - 7

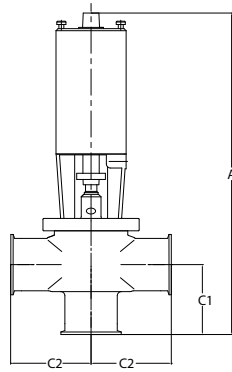

FT SRC - 9

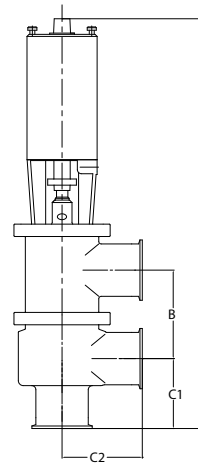

FT SRC - 77

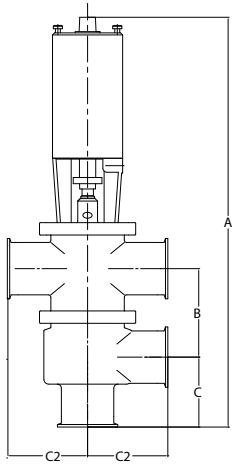

FT SRC - 79

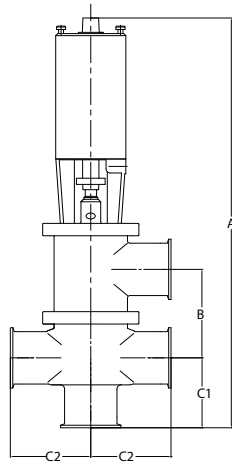

FT SRC - 97

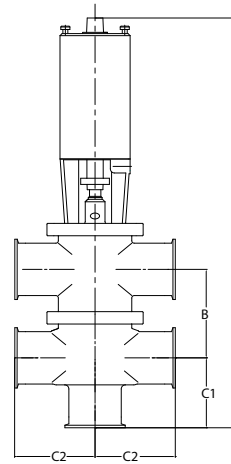

FT SRC - 99

FT SRC SHUT-OFF & DIVERT VALVES

VALVE SIZE		A								B		C1 & C2	
		Shut-Off Valves (NC)		Shut-Off Valves (NO)		Divert Valves (NC)		Divert Valves (NO)		Divert Valves			
in	mm	in	mm	in	mm	in	mm	in	mm	in	mm	in	mm
1*	25.4	12.24	311	13.07	332	14.37	365	15.26	388	2.19	56	See table below	See table below
1.5	38.1	13.58	345	14.57	370	16.38	416	17.36	441	3.11	79	2.66	67.6
2	50.8	13.98	355	14.96	380	17.68	449	18.66	474	3.70	94	2.95	75
2.5	63.5	15.31	389	16.30	414	19.69	500	20.67	525	4.45	113	3.74	95
3	76.2	17.91	455	19.17	487	22.99	584	24.25	616	5.08	129	3.94	100
4	101.6	20.75	527	22.00	559	26.65	677	27.91	709	6.42	163	5.90	150

VALVE SIZE	C			
	C1		C2	
	in	mm	in	mm
1*	2.04	51.82	3.09	78.49

*3A certification pending



Flowtrend, Inc. is not associated with, nor a distributor for, any of these manufacturers. Any name, brand, model or part number is for descriptive purposes only. Our components will fit other manufacturer's equipment and carry the OEM warranty. Alfa Laval® is a Registered Trademarks of Alfa Laval, Inc.

11512 SPACE CENTER BLVD, HOUSTON TEXAS 77059
P +1 281 990 8582 F +1 281 990 8644

WWW.FLOWTREND.COM

©2014 Flowtrend
FT SRC Seat Valve_140918

